

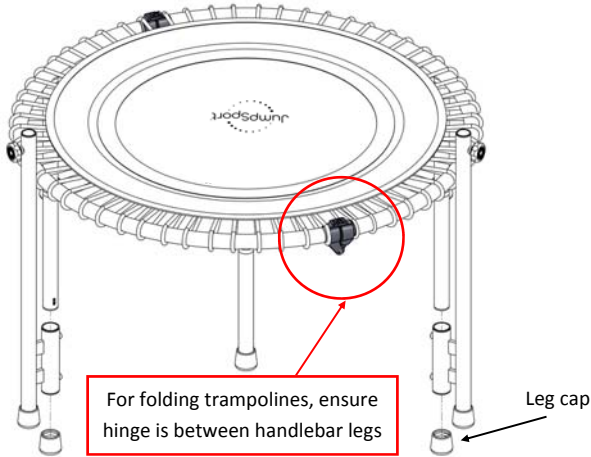

## WARNING

Read these materials prior to assembling and using this product

- If you have handle legs attached, do NOT attempt to use the rebounder without first installing the rest of the handlebar pieces.
- The exercise handlebar is not designed to support your entire weight. It is to aid with balance and provide exercise versatility.



## Installing the Handlebar

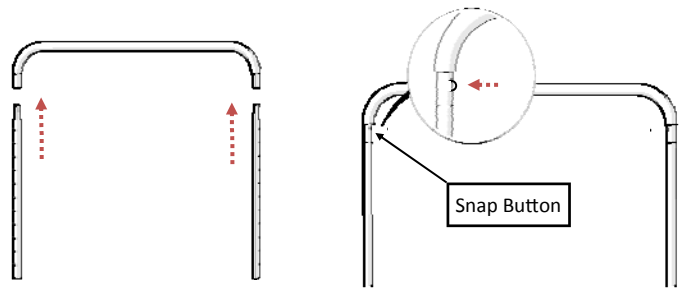

- 1) Remove two of the existing trampoline leg caps from the locations shown. For safety, if you have a folding trampoline, ensure one of the hinges is between the two HANDLE LEGS, as shown.
- 2) Slide the HANDLE LEGS onto the two trampoline legs.

- 3) Slide each end of the TOP HANDLE into one of the SIDE HANDLES. After lining up the holes, connect each side with a SNAP BUTTON, creating a top assembly.

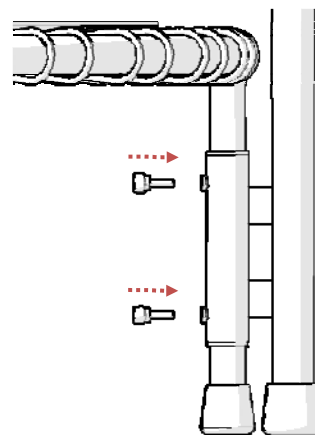
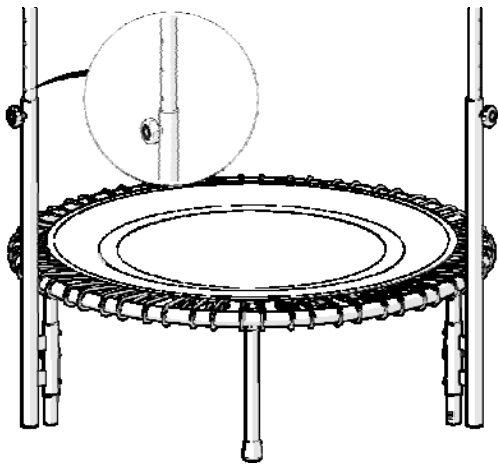

- 4) Lower the top assembly into the HANDLE LEGS until the holes line up. *Note: You may have to rotate the entire top assembly 180 degrees.* Adjust to desired height before securing with LARGE THUMB SCREWS.

- 5) Place the trampoline leg caps back on their respective legs. Handle and Trampoline legs should all be flat on the ground. Secure the HANDLE LEGS with the remaining SMALL THUMB SCREWS in the positions shown.

Retain address information for future use.



# JumpSport®

## Limited Warranty

**What is covered by this warranty?** This warranty covers any defects in materials or workmanship on all of the components of the JumpSport Exercise Handlebar, and is extended exclusively to the original retail purchaser.

**How long does this coverage last?** Warranty coverage for each component begins from the original date of purchase and lasts for 1 year (for private home use) or 90 days (for commercial or public use).

**How to submit a warranty claim for defective parts:**

1) If you notice a defective, missing, or damaged part when first receiving your product, call the JumpSport Customer Service department at 1.888.567.5867 or email [Orders@JumpSport.com](mailto:Orders@JumpSport.com) within 10 days of delivery of merchandise. You may be asked to submit photographs and/or proof of purchase for verification.

2) After using the product, if a qualifying warranty part replacement is needed, customers are required to complete the Warranty Request Form online. Once submitted and reviewed, JumpSport will either repair or replace such parts at JumpSport's discretion. To determine eligibility for warranty replacement, you may be required to either submit photos of the part or send the part to one of our designated service centers.

3) JumpSport will make a final determination whether the part is covered by this warranty. We reserve the right to examine photographs or physical evidence concerning parts claimed to be defective prior to making a final determination concerning the claim. A repaired or replacement part will be returned to you. (Shipping charges may apply.) Please allow 3 to 4 weeks for delivery.

**What is not covered by this warranty?** This warranty covers new products purchased as a complete system; it does not cover replacement parts. This warranty also does not cover expenses of on-site labor, shipping costs, travel, assembly or disassembly, or other charges associated with the repair or replacement of covered components. Further, this warranty does not cover any problem that is caused by abuse, misuse, commercial or public use of 200 Series models, ordinary wear and tear, outdoor use, weathering, acts of God (such as wind and lightning), failure to follow directions, improper installation, improper maintenance, or any silk screened graphics. Rust is a natural occurrence with any steel product and is likewise not covered by this warranty, to the extent that it does not affect the structural integrity of the part.

JUMPSPORT IS NOT RESPONSIBLE OR LIABLE FOR INDIRECT, SPECIAL, OR CONSEQUENTIAL DAMAGES ARISING OUT OF OR IN CONNECTION WITH THE USE OR PERFORMANCE OF THE PRODUCT OR OTHER DAMAGES WITH RESPECT TO ANY LOSS, INCLUDING BUT NOT LIMITED TO ECONOMIC LOSS, LOSS OF PROPERTY, LOSS OF REVENUE OR PROFITS, LOSS OF ENJOYMENT OR USE, COST OF REMOVAL, INSTALLATION OR OTHER CONSEQUENTIAL DAMAGES. SOME STATES DO NOT ALLOW THE EXCLUSION OR LIMITATION OF INCIDENTAL OR CONSEQUENTIAL DAMAGES. ACCORDINGLY, THE ABOVE LIMITATION MAY NOT APPLY TO YOU.

THE WARRANTY EXTENDED HEREUNDER IS IN LIEU OF ALL OTHER WARRANTIES AND ANY IMPLIED WARRANTY OF MERCHANTABILITY OR FITNESS FOR A PARTICULAR PURPOSE IS LIMITED IN ITS SCOPE AND DURATION TO THE TERMS SET FORTH HEREIN. SOME STATES DO NOT ALLOW LIMITATIONS ON HOW LONG AN IMPLIED WARRANTY LASTS. ACCORDINGLY, THE ABOVE LIMITATION MAY NOT APPLY TO YOU.

This warranty gives you specific legal rights. You may also have other rights which vary from state to state.

**JumpSport, Inc.**

**2055 South 7th Street, Suite A**

**San Jose, CA 95112**

**1.888.567.5867**

**<http://www.jumpsportfitness.com>**